

N<sup>o</sup> 284 The Commonwealth of Kentucky to the  
Surveyor of Pulaski County Greeting. You  
are hereby authorized and directed by  
yourself or deputy to survey in one or  
more surveys for Blufford Collyer  
two hundred acres of vacant and  
unappropriated lands in your County  
having produced to me the County Treasur-  
er's receipt for five Dollars  
the price thereof as required by Law.  
and this shall be your warrant for  
the same - Belitnefs my hand as Clerk  
of the Pulaski County Court at my office  
in the Town of Somerset this 21<sup>st</sup> day of  
October 1844 and 3<sup>rd</sup> Year of the Com-  
-monwealth -  
Executed in full authority of the Surveyor  
Lewis Patterson S.P.C. " Will Fox Clerk

lett

to 3 Land  
to 3 Warrant

collyer

---

200 acres

CCO. # 7846-

7845

Surveyed for Bluford Colyer  
 the 30<sup>th</sup> day of ~~October~~ <sup>December</sup> 1844  
 one hundred acres of Land  
 By virtue of a part of a County  
 Court Land warrant  
 of 200. acres. V 284 which  
 issued from the pulaski  
 County Court - Clerk's office the 21<sup>st</sup> day of October 1844 -  
 Situate in pulaski County on the waters of Cumberland  
 River and Bounded as followeth (To wit) Beginning at  
 a sugar tree and hickory in the pine hew hollow a corner of  
 his old Survey thence his line S 52 W 40 poles to a bunch of  
 Sowerwood his corner, his line S 44 East 42 poles to a  
 Dogwood and Sowerwood his corner, his line S 7 W 60 poles  
 to a gum whos once stood a spanish oak his corner, thence  
 his line S 38 East 80 poles to a white oak his corner, his  
 line S 19 East 78 poles to a stake, thence N 80 West 34 poles  
 to a bush and gum thence N 25 West 18 poles to two white  
 oaks thence S 63 West 10 poles to two chestnut oaks, thence  
 N 35 West 60 poles to a hickory, thence N 25 East 34 poles to  
 two poplars thence N 63 West 60 poles to a white oak and  
 Black oak, thence N 25 East 60 poles to a chestnut oak  
 thence N 45 West 62 poles to two spanish oaks, thence  
 N 60 East 84 poles to a white oak, thence S 30 East 200 poles  
 to a poplar thence thence S 33 West 24 poles to a black oak  
 and poplar thence due west 30 poles to a bush and dogwood  
 thence N 21 West 180 poles to the Beginning

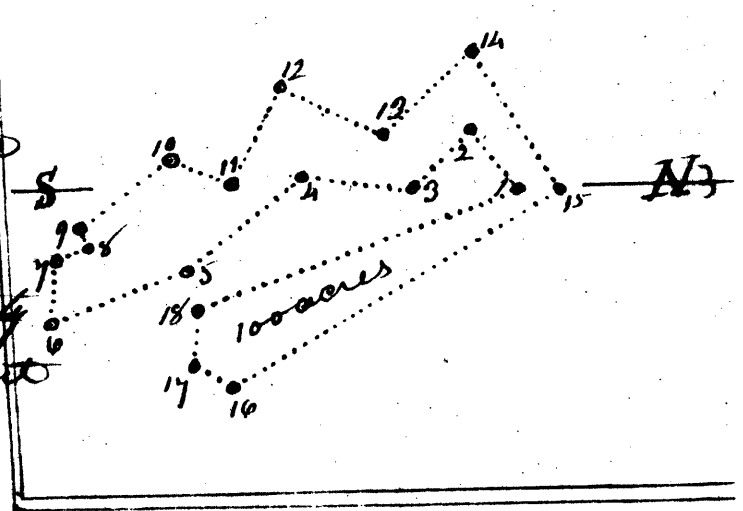

John B. Waddle } Surveyor  
 Samuel Black } chains man  
 Bluford Colyer } house keeper  
 marker & scribe }  
 Isaac Laylor D.S. for  
 Lewis Patterson S.P.  
 Lewis Patterson S.P.

Exam. Record  
 & Ex. 12

Calver Blufords  
Land plat  
100 acres

---

Exam<sup>d</sup>. Provided  
& Exam<sup>d</sup>.

Rec<sup>d</sup> 5. July 1846

Grant ip<sup>s</sup> 5 July 1846

N<sup>o</sup> 7846.

Rec<sup>d</sup> \$ 3.50 cents

cc

Bluford Colyer  
100 acres  
Pulaski  
W 7646  
Ex 4 Dto

William Cowsley ESQ.

GOVERNOR OF THE COMMONWEALTH OF KENTUCKY:

To all to whom these presents shall come, Greeting:

KNOW YE, That by virtue and in consideration of part of a warrant from the Pulaski County Court, there is granted by the said Commonwealth, unto Bluford Colyer

a certain tract or parcel of Land, containing one hundred Acres, by survey, bearing date the 3<sup>rd</sup> day of December one thousand eight hundred and forty four lying and being in the County of Pulaski on the

waters of Cumberland river and bounded as followeth to wit Beginning at a sugar tree and hickory in the Runcheon hollow a corner of his old survey thence his line south 52° N 40 poles to a bunch of sourwoods his corner his line S 7° N 60 poles to a gum where once stood a spanish oak his corner thence his line S 38° E 80 poles to a white oak his corner his line S 19° E 78 poles to a stake thence N 80° W 34 poles to a beech and gum thence N 22° W 18 poles to two white oaks thence S 65° W 10 poles to two chestnut oaks thence N 35° W 60 poles to a hickory thence N 25° E 34 poles to two poplars thence N 65° W 60 poles to a white oak and black oak thence N 25° E 60 poles to a chestnut oak thence N 41° W 60 poles to two spanish oaks thence N 60° E 84 poles to a white oak thence S 50° E 20 poles to a poplar thence S 32° W 24 poles to a black oak and poplar thence due West 30 poles to a beech and dogwood thence N 21° West 140 poles to the Beginning

With its appurtenances: To have and to hold the said tract or parcel of Land, with its appurtenances, to the said

Bluford Colyer  
and his heirs forever.

IN WITNESS WHEREOF, The said William Cowsley Esq.  
Governor of the Commonwealth of Kentucky, hath hereunto set his hand, and caused the seal  
of the Commonwealth to be affixed, at Frankfort, on the 5<sup>th</sup> day of  
July in the year of our Lord, one thousand eight hundred  
and forty six and of the Commonwealth, the fifty fifth

By the Governor,

Wm Cowsley  
Secretary of State.